

Ss Peter and Paul School

Thursday, 10 February 2022



Kia ora Parents and Caregivers,

A very warm welcome to our first newsletter of the year. A special welcome to all our new students, staff and their families who started with us last week.

Kōwhai

Henry Houghton, Max Lyttle, Roman Donaldson, Zayla Maharaj, Ainsley Melencion, Zia David, Kayana Senanayake, Evania Janet, Kaia Pison, Rylee Page, Ethan Arun, Olive Davie, Ngonidashe Bangure, Xana Panapa-McInman, Micah Antoney, Thaddeus Briones, Evana Sherin, Elizabeth Rajeev, Issac Wright and Lucas Rose

Nikau

Hejal Dahiya, Meili Angus, Matthew Clayton, Joanna Jithin, Aaryan Jain, Mary Rasho, Reese Dadulo and Miss Caitlin Fitzgerald.

Pohutukawa

Tianli Angus, Neha Bipin, Grant Tongco, Aalya Jain, Jessica Marryatt, Omalmi Silva, Demetrius Wright, Valentina Rasho, Sophia Rose.

Rata

Jada Tetevano, Fathima Sherifdeen, Caprie Falleni-Tonga, Ella Collier, Charlotte Cowley, Anushka Raj, Sian Campbell, Isabelle Hunger, Jiali Angus, Shania Noronha, Mila Duncan, Adiya Sehrawat and Mrs Laura Rose.

We were hoping to have a full school Powhiri and invite parents to join us but unfortunately we will have to hold that good idea for another time. However, all these students and teachers received a special welcome at their Area gatherings outside, under the shade last week. We hope they all settle quickly into their new school and feel right at home here.

Preparedness Planning

We continue with our preparedness planning for managing COVID-19. A public health toolkit, designed to support the Ministry of Education to work with school communities to support the management of COVID-19 contacts within their environments, when a case has been infectious on site, has been provided for all schools. This very useful documents provides a wealth of information and advice including:

Clarity around the various scenarios that would determine if a student or staff member is a close or casual contact

What would happen if a case is confirmed at a school - the steps we would need to take to notify students, staff and families, and anyone else who may have been on our premises at the time

The use of the word 'case' is quite problematic

as it does sound quite impersonal when what we really mean is that a valued member of our community; student or staff has become unwell. Somebody has to be that first 'case' and then the second etc so please know that our prayers and good wishes will always be with you and that quick action to alert us is the most important thing.

With your support, we are already doing many things to further reduce the risk and impact of a COVID-19 case. Now that most children have settled into school we are grateful for your efforts to do drop offs and pick ups at the school gates. It's also very clear to see that people are scanning in and wearing a mask should they need to come on site. Thank you!

Changes for students

The children are amazing at how adaptable they are around these new requirements and it's not just inside the classroom with mask wearing and designated seating etc but out in the playground as well. You may have heard from your children that we have grouped parts of the playground spaces and apart from Kowhai who remain in their part of the school, the other Areas rotate daily around these 3 grouped spaces. We encourage students to see this as an opportunity to play in parts of the school they might not normally have played and to try new games and activities. We are constantly monitoring this and adapting our spaces as needed.

Staff news

You may not be aware but after 30 years of incredibly dedicated service as a teacher aide and more recently our school Property Manager, Vicki Johnston, will be moving into a most deserved retirement mid way through next month.

[Here is the link to our Seek Advertisement](#) looking for a new Wonderwoman or Superman to replace our wonderful Vicki. Please share freely amongst your family and friends

Rachael, our friendly and caring Office Administrator is making a new career move at the end of the month so we will be very sorry to bid her farewell too. Rachael's wonderful contributions both as one of the first contacts that families make with the school and as a teacher aide will be much missed. We are grateful to already have Teresa Evans on staff and she will be taking over Rachael's administration tasks.

Kay Tester

OUR WEBSITE



PARISH WEBSITE



From our Principal
The Office
Special Character
Kowhai
Nikau
Pohutukawa
Rata
School Sports

Events

Thursday 10 February
Lunches Online starts

Thursday 17 February
Bee Healthy - Dental Van arrives

Friday 18 February
Scholastic Book orders due by 4pm

**BACK
-to-
SCHOOL**

THE OFFICE

Back to School 2022

Cell phones / smart watches

A friendly reminder to please follow the below procedures if your child is bringing a Cellphone or Smartwatch to school.

- They must be put in the classroom minding box on arrival at school and will be returned to the student at the end of the school day
- Failure to follow these procedures will mean the device is removed from the student, sent to the office and parents will be rung to collect the item at their convenience.

Should the school need to contact parents for any reason during the school day you will receive a phone call from the office about this. This very simple process has worked effectively for many decades now and allows parents to feel confident that their child is well looked after during the school day. The widespread use of cell phones has certainly meant schools can more quickly communicate with parents should anything arise. As you can imagine, the main reason for contacting parents during the school day is due to illness or an injury on the playground.

Scholastic



A Scholastic Book Club brochure will come home this week. A brochure will come home once a term. Orders are to be placed online by 4pm Fri 18 Feb at mybookclub.scholastic.co.nz using LOOP (Linked Online Ordering and Payment for Parents). Orders cannot be made at school. When ordering, to find our school you will need to enter our postcode '5010' and/or our school's name 'St Peter and Paul School'. All online orders will be sent directly to the school and given to your child.

Parking Reminder

Could we please remind our parent community to avoid making use of the Church carpark for parking or as a drive through for drop offs and pickups. Many thanks.



A friendly reminder that if you are running late and have reported this through the website or telephone, your child will still need to sign-in (on the tablet) at the office and take a red card before going to their classroom.

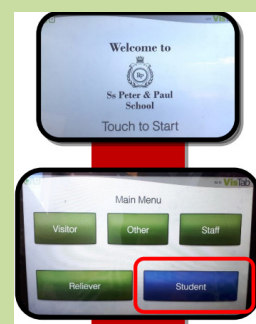

Uniform Shop

Our Uniform Shop is open **Wednesdays by appointment only** from 2-4pm (term time). Please email Teresa on uniform@stpeterpaul.school.nz to arrange a booking. If you would like to place an online order, please [click here](#) and proceed to email your order to Teresa. When payment has been received an email will be sent informing you that your order is ready to collect. If you need to exchange an item please coordinate this directly with Teresa via email. **We are unable to take any orders through the office or via our Admin email address.** Please remember all orders are subject to available stock as we have been experiencing delays with couriers. We thank you for your understanding and support.

SPECIAL CHARACTER

Back to School 2022

In Religious Education lessons this year we will be focussing on a common theme: RELATIONSHIPS. This overarching concept aims to help our students develop a better understanding of their relationships with Jesus, with our environment and with each other, and weaving these through our school values. As our students learn about Jesus' teachings, Bible stories, sacraments, and prayers, we will incorporate the use of the Depth and Complexity framework. This will encourage the students to think more deeply and enhance their understanding of each focus.

The staff were very fortunate to have worked with Anna-Maria Vissers, Wellington RE adviser during our Teacher Only Day, exploring approaches and developing our understanding of how to plan for and engage our students in their learning.

'We are the guardians of one another and of nature'

Pope Francis

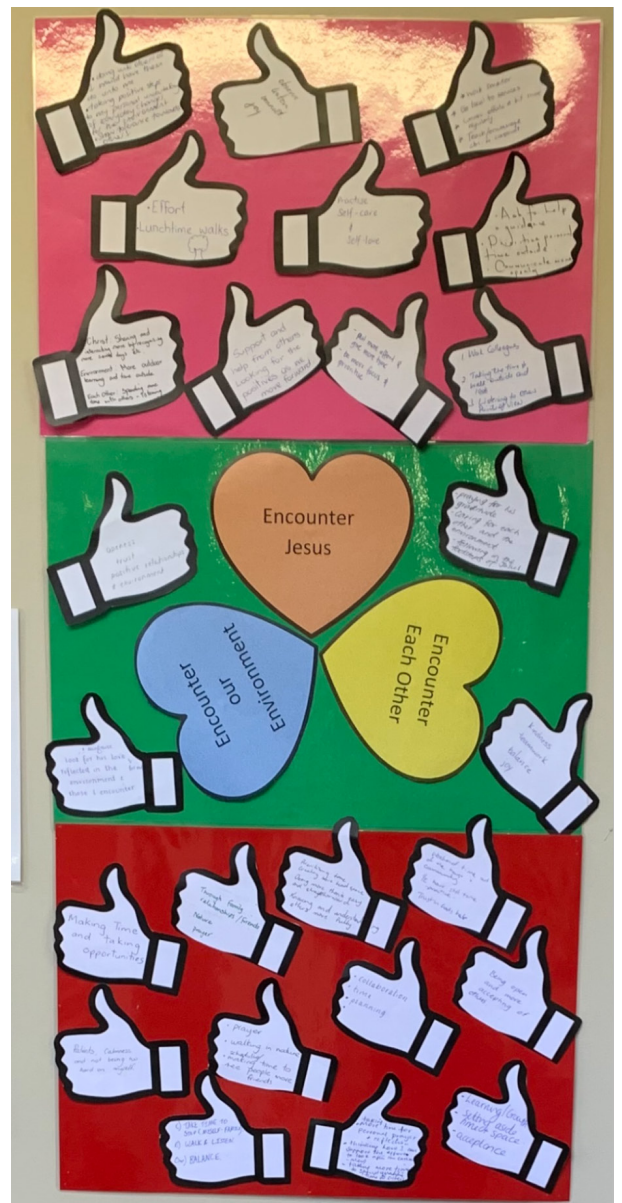

KOWHAI

Back to School 2022



We have started the term with so much enthusiasm in Kowhai! Students have been adjusting to their new classroom environments, getting to know their teacher and of course getting to know one another. On Friday we had a lovely gathering under the shade of the trees for our Area Hui. It was a lovely time to reconnect, learn a little bit more about the teachers and of course welcome and introduce all of our new friends to the cohort. We would also like to take the opportunity to say “Kia ora” and “Welcome” to the brand new parents and caregivers that

have joined our school community this term. Keep an eye out for our Area News Letter coming out in the next few weeks where you will find more detail of upcoming events and learning we have planned for this term.





NIKAU

Back to School 2022



In Nikau we have all started the new year with enthusiasm and excitement. We have been so delighted to see how the students have taken the changes at school in their stride.

Our focus this term is to build supportive relationships, set up classroom routines and to ensure all students feel connected and ready to learn.

We are making the most of the weather with as much outside learning as possible. At fitness time we are focused on developing our gross motor skills. We've been exploring different ways to develop body awareness, balance and strength through fun activities.

POHUTUKAWA

Back to School 2022

What a great start to the new year for Pohutukawa students and teachers. New furniture was delivered over the holidays and has added a fresh new look that we all love. Not only have we been enjoying the new furniture but we have also been getting to know one another and welcoming the new

students to our school. Each class has started to explore the concept of 'Relationships' which is our new universal theme for the year. We look forward to sharing more of our learning around the universal theme in school newsletters throughout the year.



School Lunches

Sushi and Subway

delivered to school weekly

It's simple; all you need to do is register at

www.lunchonline.co.nz

and follow four easy steps to get started

- 1 Register an account
- 2 Add member/s including your child's name, school and classroom
- 3 Make a payment so you have funds in your account before you order
- 4 Select your lunch and place an order

 lunchonline

0800 565 565

info@lunchonline.co.nz

BACK
-to-
SCHOOL

Lunches start Thursday 10 February

Lunches start

Thursday 10 February

RATA

Back to School 2022



In Rata we spent some time with Mrs Owen discussing the reasons why we do art. We concluded it is to help us become better observers who can make meaningful connections and critically construct thoughtful thinking and consequently artwork.

Here is a taste of the writing and some photos of the first lessons observational drawing.

“We do art to express our emotions.”

“We do art to imagine and tell of magical worlds.”

“We do art to look closely, especially at nature.”

“We do art to express yourself instead speaking out, and to tell stories without words.”

“Art is your own realm where you can visually communicate your ideas.”

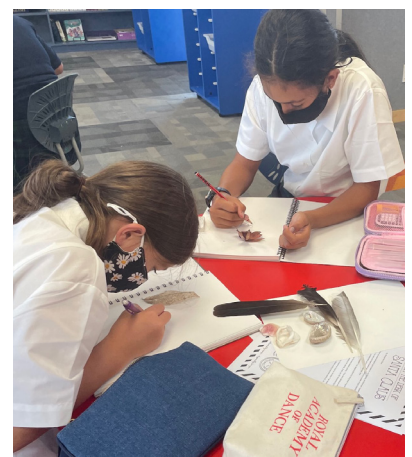
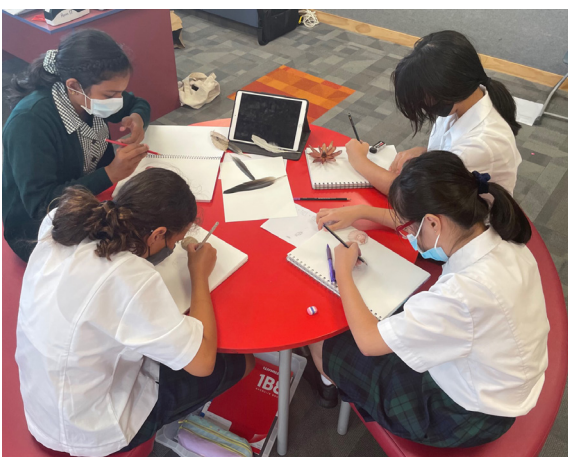



SPORT

Back to School 2022

Thanks to everyone who has completed their Touch and Netball (Year 1 to 4) registrations.

The present situation has meant that we do have some restrictions around spectators and all coaches and managers must supply the school with proof of vaccination. We thank those who have volunteered and completed this task.

It is most important that parents remember to transfer their payment when registering a child for a sporting activity or they may not be named in a team.

Netball, Years 5 to 8

Registrations for Netball for these groups will be distributed by email to all parents who have students in Years 5 to 8. Please note that Year 5,6 play on a Monday after school and Year 7,8 on a Saturday.

We as always will need volunteers to coach and manage these teams.

Trials will be held for Year 7,8 as is outlined in the registration information. Year 5,6 will have their trials if needed completed at school.

These registrations will both close on Wednesday 23rd February at 3pm.

The payment required includes money to pay umpires and the administration fee as outlined above.

Outside School Sport

Unlike music, dance etc many sports organisations go through the schools to access students to enrol in their teams. While we are very keen to support sport at all levels we also have to be sure that we cover our costs as we do not allocate funding from our school budget to cover outside school sport conducted by other groups. Our school budget covers purchase of new equipment, costs related to Zone events, buses to sports events & activities, hireage of facilities etc.

Therefore, as per the previous year, the cost for all our outside school hours sports includes a \$5 administration fee per child. This is to cover the completion of administration tasks for an outside organisation/business which involves, at school level, compilation of registration forms, sending these out, completing team makeups once registrations are received, checking payments, processing payments, all communication with parents on an ongoing basis, attending meetings etc.

Have you joined the PTA Facebook group yet?
Stay up-to-date with school community events
by joining our page!

